

## 21 Meikle Bin Brae, Lennoxton, Glasgow, G66 7BU

Fixed Asking Price £70,000

- One bedroom lower cottage flat
- Double bedroom
- Private rear garden
- Council Tax Band B
- Spacious lounge
- Three piece bathroom suite
- Driveway
- Fitted kitchen
- Gas central heating
- EER- C

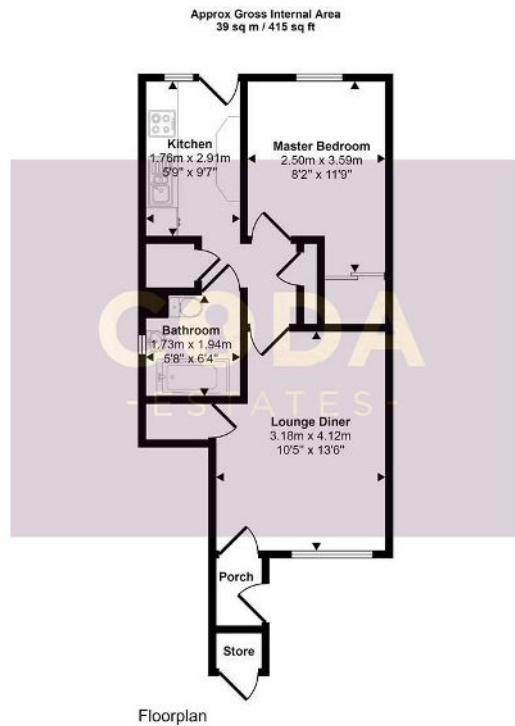

This floorplan is only for illustrative purposes and is not to scale. Measurements of rooms, doors, windows, and any items are approximate and no responsibility is taken for any error, omission or mis-statement. Icons of items such as bathroom suites are representations only and may not look like the real items. Made with Made Snappy 360.

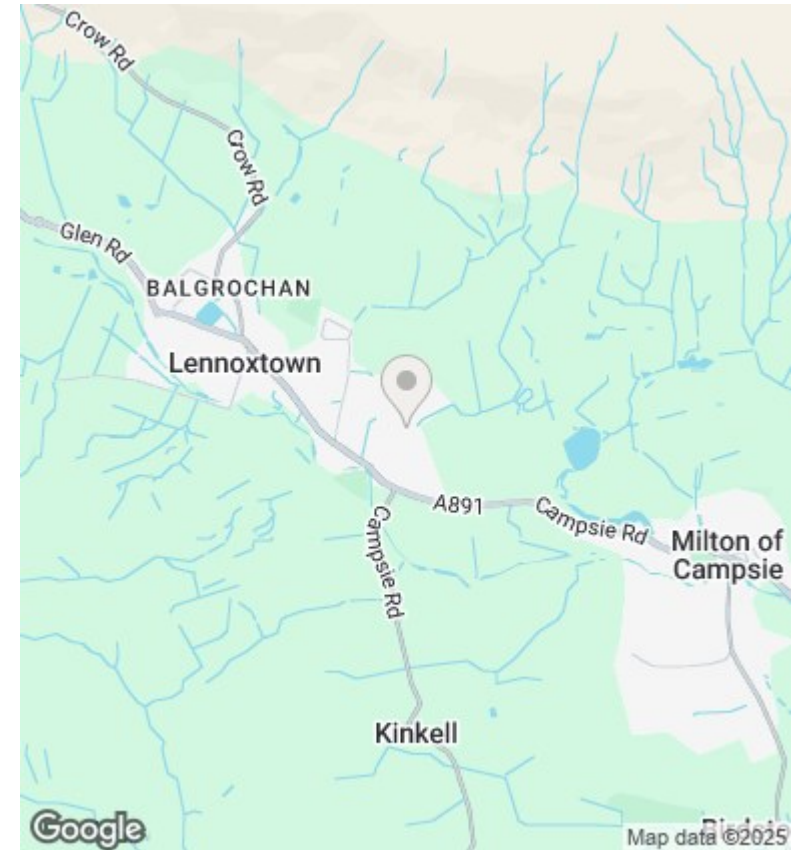

## Directions

## Viewings

Viewings by arrangement only. Call 01417751050 to make an appointment.

## Council Tax Band

B

## EPC Rating:

C

Energy Efficiency Rating		Current	Potential
<i>Very energy efficient - lower running costs</i>			
(92 plus)	A		
(81-91)	B		
(69-80)	C	74	77
(55-68)	D		
(39-54)	E		
(21-38)	F		
(1-20)	G		
<i>Not energy efficient - higher running costs</i>			
<b>Scotland</b>		EU Directive 2002/91/EC	